

DIAGRAMMATIC PLANS OF SALISBURY CATHEDRAL AND ST TEILO'S CHURCH

IDENTIFYING SPACES USED FOR THE ENACTMENTS

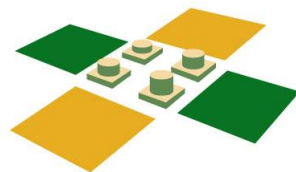

THE
EXPERIENCE
OF WORSHIP

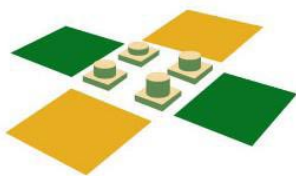

THE
EXPERIENCE
OF WORSHIP
IN LATE MEDIEVAL
CATHEDRAL AND
PARISH CHURCH

INVESTIGATION
REALISATION
INTERPRETATION



photograph by Ash Mills

SALISBURY CATHEDRAL
ST TEILO'S CHURCH
DIAGRAMMATIC PLANS OF THE BUILDINGS
AND THE LOCATIONS OF
THE ENACTED LATE MEDIEVAL LITURGIES

The Experience of Worship in late medieval Cathedral and Parish Church,
a research project initiated in the School of Music, Bangor University,
as part of the AHRC-ESRC *Religion and Society* research programme.



Arts & Humanities
Research Council

PARISH CHURCH OF ST TEILO LLANDEILO TALYBONT

St Teilo's in relation to Salisbury Cathedral

Salisbury: internal length c.450 feet, 135 metres

St Teilo: internal length c.56 feet, 17 metres

St Teilo's E to W roughly equivalent to Salisbury Great Transept E to W

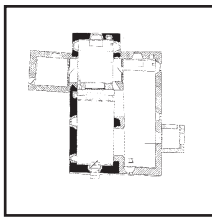

Plan of St Teilo on a scale comparable to that of Salisbury on the previous page



photograph by Neil Moody-Jones

Spaces for worship for clergy and people



Jesus chapel
(*Jesus Mass*)



Chancel (clergy)



Nave (people)
(*Lady Mass*)

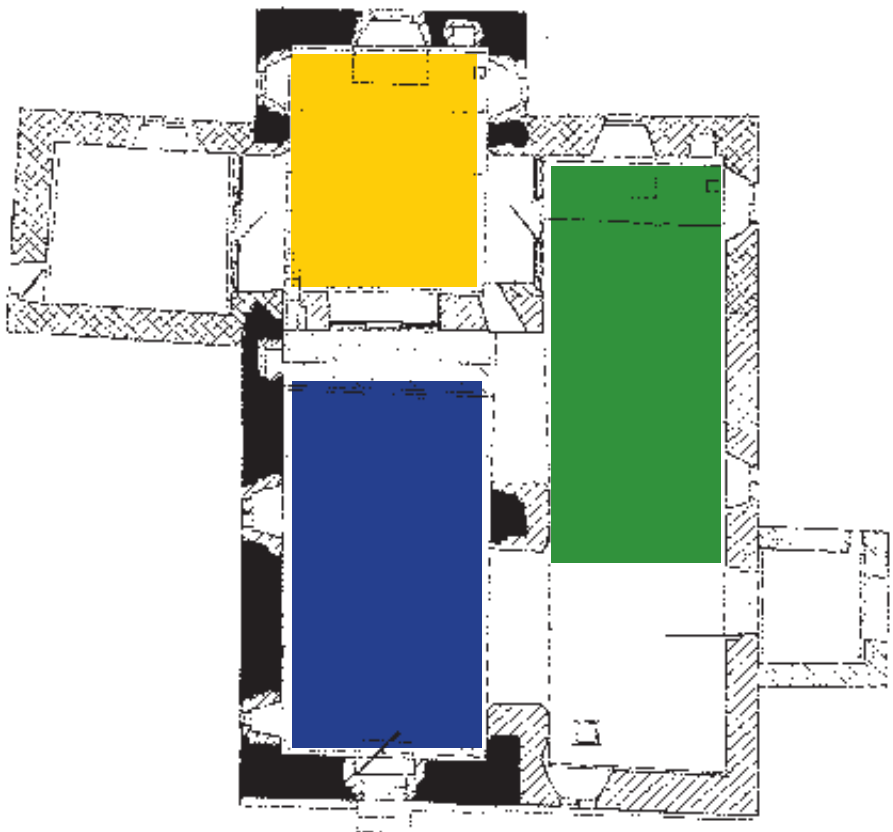

St Teilo's Church was moved from its original site where it was falling derelict, and is now located in St Fagans: National History Museum Wales, near Cardiff, where it is being decorated and furnished as it may have been c.1520.