



THE
EXPERIENCE
OF WORSHIP
IN LATE MEDIEVAL
CATHEDRAL AND
PARISH CHURCH

WORKING WITH PARTNERS

Salisbury Cathedral



Photos, Salisbury Cathedral

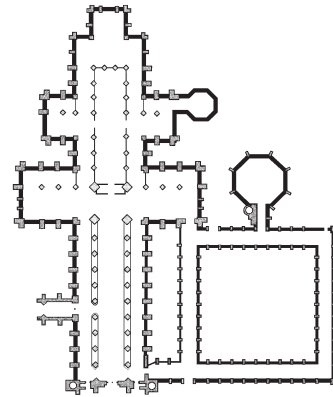

Salisbury Cathedral: interior length 450 ft - 135 metres



Image from video, Andy Brice

Salisbury offered the project a great medieval cathedral, and the rich resources of choir and clergy.

St Fagans: National History Museum Wales



Photo, Neil Moody-Jones

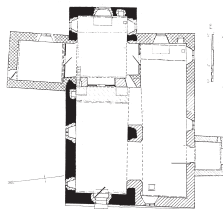

St Teilo's Church
interior length
56 ft - 17 metres



Images from video, Andy Brice

The medieval parish church of St Teilo is tiny by comparison with Salisbury, but followed a similar pattern of services in the Middle Ages in a smaller space with far fewer resources. The exterior and interior are presented as in about 1520. These two locations provided spaces for liturgical enactments.

